

Zebra ET51/ET56 Enterprise Tablets – Android or Windows

Accessories Guide

Contact **mobit** for more info:

- DE/EN/IT: **+41 (0)44 800 16 30**, CH-8306 Brüttisellen
- FR: **+41 (0)21 651 98 98**, CH-1020 Renens
- E-mail: info@mobit.ch
- Contact form on www.mobit.ch



Zebra ET51/ET56 – Accessory Overview



Zebra ET51/ET56 – Cradles and Chargers

4-Slot ShareCradle



CRD-ET5X-SE4CO1-01
ET5X 4-Slot Charge Only Cradle

- Introducing the ShareCradle System:
 - Terminal & Spare Battery Cups designed to be shared across the Zebra suite of Charge Only bases providing flexible & future proofed charging solutions.
- Solution for either: 4 ET5x or 4 ET5x & PowerPack Charger
- Option to mount and power a 4-Slot PowerPack Charger
- Fits on a tabletop, wall mounted, or rack mounted (requires 19 in. rack mounting accessory)
- Accepts ET5x Tablets with or without **Expansion Backs**
- Accepts ET5x Tablets with or without **Rugged Frames**
- **Note:** ShareCradles require Power Supply (PWR-BGA12V108W0WW), DC Line Cord (CBL-DC-382A1-01), and country specific AC Line Cord (e.g. 23844-00-00R); **Sold Separately**



4-Slot PowerPack Charger



SAC-ET5X-4PPK1-01
ET5X 4-Slot Battery Charger for Optional PowerPack

- Standalone 4-slot charger with charge state indicator LEDs
- Can be docked in 4-slot ShareCradle via adapter cup
 - Still requires its own power supply
- **Note:** 4-Slot PowerPack Chargers require Power Supply (PWR-BGA12V50W0WW), DC Line Cord (CBL-DC-388A1-01), and country specific AC Line Cord (e.g. 23844-00-00R); **Sold Separately**



don't forget:
102651 (mobit.ch)
CH Power Cable "Standard"
(T12-C13, 3-pin, black, 2m)

Zebra ET51/ET56 – Docks and Ports

Charge Only 1-Slot Dock



CRD-ET5X-1SCG2

ET5X 1-Slot Charge Only Dock

- Supports charging with and without Rugged Frames
- Only works with exposed standard (not rugged) connector
- Accepts ET5x Tablets with or without **Expansion Backs**
- Accepts ET5x Tablets with or without **Rugged Frames**
- **Note:** Requires Power Supply (PWR-BGA12V50W0WW), DC Line Cord (CBL-DC-388A1-01), and country specific AC Line Cord (e.g. 23844-00-00R); **Sold Separately**



Charge & Communication 1-Slot Dock



CRD-ET5X-1SCOM1

ET5X 1-Slot Charge and Communication Dock

- Supports charging with and without Rugged Frames
- Charges and extends I/O for: HDMI, Ethernet & 3 USB ports
- Accepts ET5x Tablets with or without **Expansion Backs**
- Accepts ET5x Tablets with or without **Rugged Frames**
 - *Does not support Rugged I/O connector in the Rugged Frame*
- **Note:** Requires Power Supply (PWR-BGA12V50W0WW), DC Line Cord (CBL-DC-388A1-01), and country specific AC Line Cord (e.g. 23844-00-00R); **Sold Separately**



ET51/ET56 – Docks and Rugged Connectors

Rugged Charge & Comms 1-Slot Dock



CRD-ET5X-1SCOM1R

1-Slot Dock with Rugged IO Adapter

- Charges & extends Rugged I/O for HDMI, Ethernet, 3 USB Ports
- Only works with Rugged Frame with Rugged I/O Connector
- **Note:** Requires Power Supply (PWR-BGA12V50W0WW), DC Line Cord (CBL-DC-388A1-01), and country specific AC Line Cord (e.g. 23844-00-00R); **Sold Separately**



Rugged Charging Adaptors



CHG-ET5X-CBL1-01

Rugged Charge Connector (Charge dongle)

- Rugged charge cable breaks away to prevent tablet damage
- DC barrel input on the side
- Works on tablets with or without Rugged Frames
- Includes shim to use with tablets without Rugged Frames
- **Note:** Require Power Supply (PWR-BGA12V50W0WW), DC Line Cord (CBL-DC-388A1-01), and country specific AC Line Cord (e.g. 23844-00-00R); **Sold Separately**



SG-ET5X-RGIO2-01

Replacement Rugged I/O Connector

- Replacement I/O connector for Rugged Frames (if needed)
- This part is included when ordering a new Rugged Frame
 - (e.g. SGET5X-8RCSE2-02, SG-ET5X-10RCSE2-01)

Zebra ET51/ET56 – Frames, Clips and Tethers

8 in. & 10 in. Rugged Frames



SG-ET5X-8RCSE2-02

8 in. Rugged Frame with Rugged I/O connector (Included)



SG-ET5X-10RCSE2-01

10 in. Rugged Frame with Rugged I/O connector (Included)

- Improves drop protection to 6 ft / 2 m to concrete
- Sealed I/O connector replaces bottom dust cover
- Screw bosses on back to attach hand and shoulder straps
- Works with or without Expansion Backs

D-Clips & Tethers



SG-ET5X-DCLIP2-02

2 D-Clips attach to screw bosses in rugged frame



SG-TC7X-STYLUS-03

TC7X 3-Pack STYLUS + TETHER

- TC7X passive stylus (no batteries needed, more durable)
- 3-Pack + Tether (single stylus unit is not available)
- **Note:** will not work in areas where water is pooled on the screen



SG-ET5X-SLTETR-01

Stylus coil tether

- Coiled tether provides a convenient method to keep your tablet and pen together without compromising your usage experience

Scanner Extensions with Hand Strap

SE4750 for Windows or Android OS



ZBK-ET5X-8SCN5-01 (Windows, 8 in.)
ZBK-ET5X-8SCN5-02 (Android, 8 in.)

ZBK-ET5X-10SCN5-01 (Windows, 10 in.)
ZBK-ET5X-10SCN5-02 (Android, 10 in.)

- Rotating Hand Strap base with Integrated Scanner
- Expansion back screws to back of tablet; replacing battery door
- Captures 1-D and 2-D bar codes in virtually any conditions, at lightning speed via Laser aimer
- **Note:** Optional Auxiliary PowerPack (**BTRY-ET5X-PRPK1-01**; ***sold separately***) can be inserted in base

SE4710 for Windows OS ****Only****



ZBK-ET5X-8SCN1-01 (8 in.)

ZBK-ET5X-10SCN1-01 (10 in.)

- Rotating Hand Strap base with Integrated Scanner
- Expansion back screws to back of tablet; replacing battery door
- Captures 1-D and 2-D bar codes via LED aimer (Indoor use)
- **Note:** Optional Auxiliary PowerPack (**BTRY-ET5X-PRPK1-01**; ***sold separately***) can be inserted in base

ET51/ET56 – Expansion Back and Power Pack

Expansion Back (No Scanner)



ZBK-ET5X-8RH1-01 (8 in.)

ZBK-ET5X-10RH1-01 (10 in.)

- Expansion back screws to back of tablet; replacing battery door
- Rotating Hand Strap base
- **Note:** Optional Auxiliary PowerPack (**BTRY-ET5X-PRPK1-01**; *sold separately*) can be inserted in base

Auxiliary PowerPack Battery

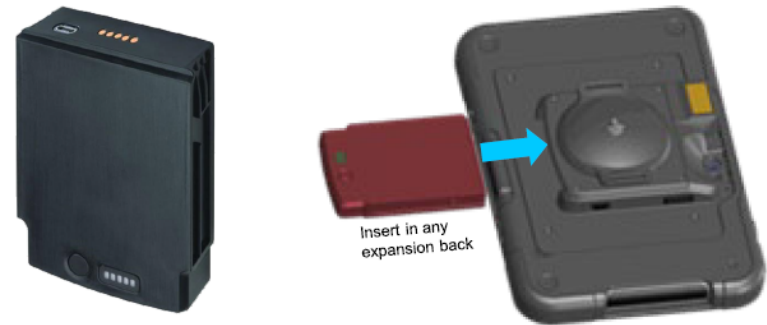

BTRY-ET5X-PRPK1-01

24.5Wh of additional charging capacity (3400mAh @ 7.2V)

- Hot swappable; enables 24x7 usage
- Can be used in addition to the main battery capacity
- Charges with 4-slot battery charger (**SAC-ET5X-4PPK1-01**)
- Charges when Tablet & Expansion Back are in 1-slot Dock or ShareCradle
- Gas Gauge LED to display the amount of charge
- **Note:** Designed for use with any Expansion Back

Zebra ET51/ET56 – Internal Batteries

Internal Batteries for *Android* OS



BTRY-ET5X-8IN5-01
8 in. Tablet Internal Battery

- 6440mAh / 3.8V / 24.4Wh
- Rechargeable Li-Polymer; User replaceable
- 5-6 hours continuous WLAN usage with display on



BTRY-ET5X-10IN5-01
10 in. Tablet Internal Battery

- 9660mAh / 3.85V / 37.1Wh
- Rechargeable Li-Polymer; User replaceable
- 8-9 hrs continuous WLAN usage with display on
- **Note:** ET50 / ET55 internal batteries are **NOT COMPATIBLE** with the new ET51 / ET56 Tablets (and vice versa)

Internal Batteries for *Windows* OS



BTRY-ET5X-8IN3-01
8 in. Tablet Internal Battery

- 3300mAh / 7.6V / 25.1Wh
- Rechargeable Li-Polymer; User replaceable
- 5-6 hours continuous WLAN usage with display on



BTRY-ET5X-10IN3-01
10 in. Tablet Internal Battery

- 4950mAh / 7.7V / 38.1Wh
- Rechargeable Li-Polymer; User replaceable
- 8-9 hrs continuous WLAN usage with display on
- **Note:** ET50 / ET55 internal batteries are **NOT COMPATIBLE** with the new ET51 / ET56 Tablets (and vice versa)

Zebra ET51/ET56 – Cases and Straps

8 in. & 10 in. Operations Case



FRONT VIEW

SG-ET5X-8HLST-01
8 in. Operations Case



BACK VIEW

SG-ET5X-10HLST-01
10 in. Operations Case

- Supports tablet *without* rugged frame
- Made of a leather with a pen loop for stylus
- D-Clip points in 4 corners support addition of:
 - Hand strap (sold separately)
 - Shoulder strap (sold separately)
- Mounting points accommodate additional accessories
- Works with or without Expansion Backs

Shoulder & Hand Straps



SG-ET5X-SHDRSTP-01
Break away Shoulder Strap



SG-ET5X-HNDSTP-01
Handle strap

- Hand & Shoulder straps attach to rugged frame via D-Clips
- Break away shoulder strap releases from tablet to prevent damage when snagged
- Handle strap has plastic grips for carrying comfort

Rugged Mounting Docks and Cradles

Contact **mobit** for more info:

- DE/EN/IT: **+41 (0)44 800 16 30**,
CH-8306 Brüttisellen
- FR: **+41 (0)21 651 98 98**,
CH-1020 Renens
- E-mail: info@mobit.ch
- Contact form on www.mobit.ch



Zebra ET51/ET56 Enterprise Tablets – Android or Windows

Accessories Guide

Contact **mobit** for more info:

- DE/EN/IT: **+41 (0)44 800 16 30**, CH-8306 Brüttisellen
- FR: **+41 (0)21 651 98 98**, CH-1020 Renens
- E-mail: info@mobit.ch
- Contact form on www.mobit.ch

